



B50FL
B50DL
B50WL
B75RFL
B75RDL

Instruction of installation :

- Read the instructions carefully before installation and commissioning.
- The safety of the device can only be guaranteed on condition that to be respected the following instructions, both stages of installation and use therefore it is highly recommended to keep them.
- When installing, always observe the national installation and accident prevention regulations.
- Installation and commissioning may only be carried out by authorized specialists.
- The device cannot be in any case modified or forced, any modification might jeopardize the safety system making it dangerous. LiteMatrix declines any responsibility on modified products



FOR INDOOR USE ONLY!

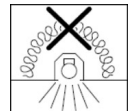
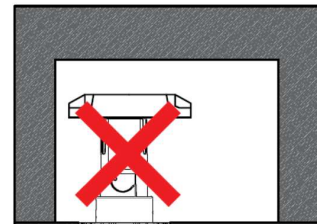
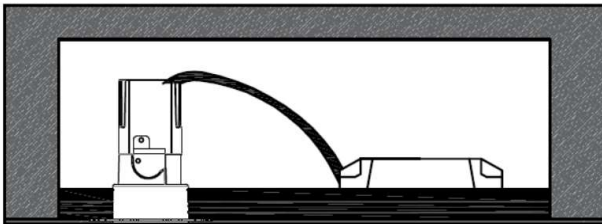

ATTENTION: For ceiling recessed mounting. Luminaire not suitable for being covered with heavy staffs or thermally insulating materials.

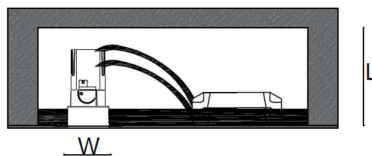
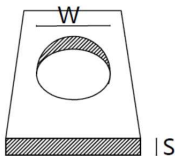
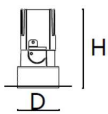

Table 1-Specs

	Aperture	Height	Cutout	Thickness	Depth
	D/mm	H/mm	W/mm	S/mm	mm
B50FT	Φ50	94	Φ54	5-25	>130
B50DT	Φ50	98-108	Φ54	5-25	>130
B50WT	Φ50	84	Φ54	5-25	>130
B75RFT	Φ75	116	Φ80	5-25	>140
B75RDT	Φ75	121	Φ80	5-25	>140

-Lateral air space under EN 60598: The lateral distance between the surface of the luminaire and any parts of the building must be no less than 50mm.

-Please be sure enough space has been left for mounting.

-Recommended mounting and using environment: Ta=25°C.

Luminaire mounting

1. During the installation, make sure the power supply is disconnected. Put on gloves and operate in dry environment
2. Ceiling cutout

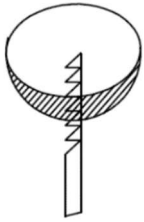
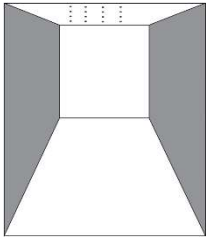

3. Casing mounting

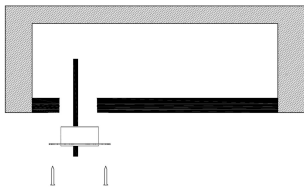

4. Mounting surface treatment

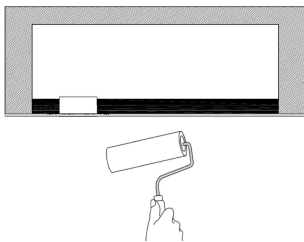

5. Connect to power supply

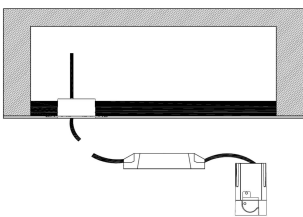

6. Put power supply and luminaire into the ceiling

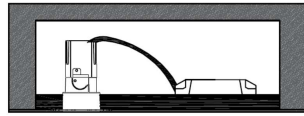

Accessory mounting

1. Following these steps below to install or change the reflector

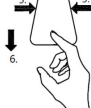
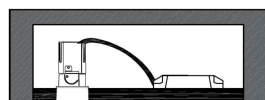
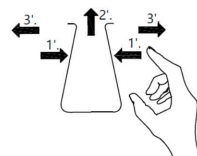
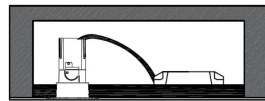
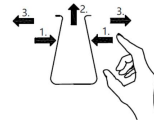
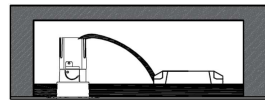

ATTENTION: Make sure the mounting direction of reflector is correct as below for B50D models.

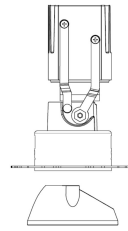

Adjustment for B50DT

Remove the reflector, using mechanical wrench to adjust.

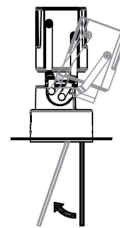
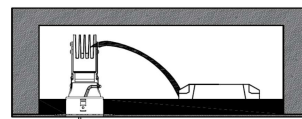
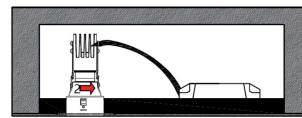

Adjustment for B75RDT

Remove the reflector, using fingers to adjust.

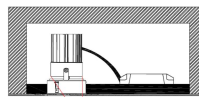

Cleaning

Always clean carefully using a soft cloth and a commercially available, pH-neutral, alcohol-free, non-abrasive cleaning agent.

Disposal



In accordance with EU Directive WEEE (Waste Electrical and Electronic Equipment), luminaires must not be disposed of with other household waste. At the end of their life, luminaires must be taken to the appropriate local facility available for the disposal or recycling of electronic products.